

# Case Study: King Edward VI Handsworth Wood Girls Academy

Self contained 6<sup>th</sup> form centre.

biophilic  
by nature

TG ESCAPES  
modular eco-buildings



King Edward VI Handsworth Wood Girls' Academy needed additional stand alone space to house their 6th form year group away from the main school building. They wanted something special to help encourage the students to stay on to year 12. This 514 square metre building containing common room and seminar rooms was completed on time and in budget in April 2021. Price £667k net at completion.

*"Overall, a very good experience working with the TG Escapes team from the initial on-site meeting to formulation of drawings to the construction of the new building and completion."*

*Hoang Nguyen Estates and Facilities Manager*

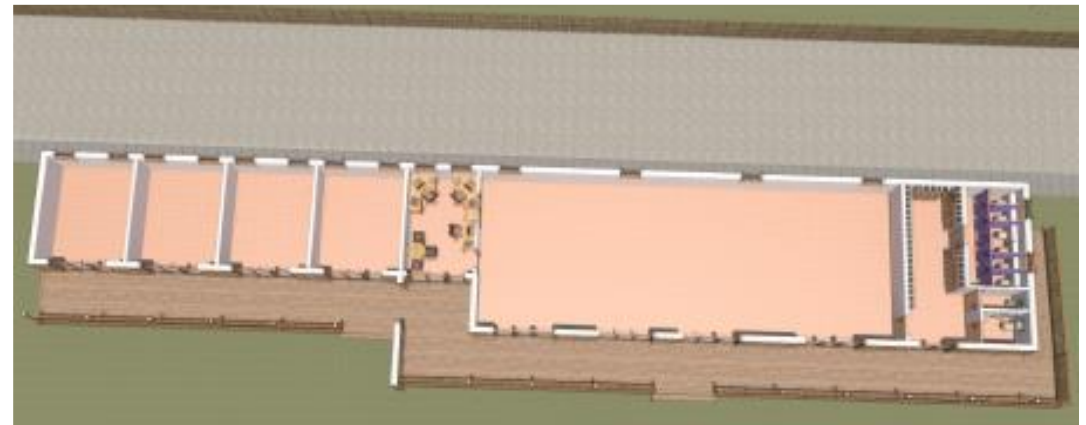

Why did you want to develop additional space?

The 6th form students were formerly based in the main school in an area which was not fit for young adults, there was no separation for the 6th formers from the main school year groups and we wanted to give them their own space away from the main school.

What made TG Escapes stand out from other providers?

The eco approach and the design of the building stood out from the rest of the providers. The initial contact with the surveyor was very personable and it was clear he was there to help us achieve our objectives.

What are the biggest benefits you have noticed for the pupils and staff?

The building has given the 6th form students and 6th form staff a sense of pride and ownership and has definitely lifted their spirits. They have seen the building being constructed and were eagerly waiting to take occupancy!

